



Driwall™ Rainscreen Products

Driwall™ Rainscreen is a drainage mat for exterior wall systems. The entangled net product eliminates incidental moisture problems in most exterior veneer applications, including stucco, manufactured stone, and plank siding.

With the increase in building “tightness” for thermal protection, moisture problems are on the rise, causing a greater need for hydrostatic pressure release and a ventilation method.

The full-wall Driwall™ Rainscreen product rolls over the weather-resistant barrier to separate it from the exterior veneer. The airspace that Driwall™ Rainscreen creates increases airflow through the wall cavity, allowing the wall to breath and stay dry.

The end result: a dry, mold-free wall system from KEENE!

Benefits

- ✓ LEED® credits available
- ✓ Prevents callbacks from moisture problems
- ✓ Increases ventilation
- ✓ Helps prevent mold
- ✓ Most effective way to drain and vent
- ✓ One product that can do it all



*Photo:
Stone and Stucco Home
with Driwall™ Rainscreen*

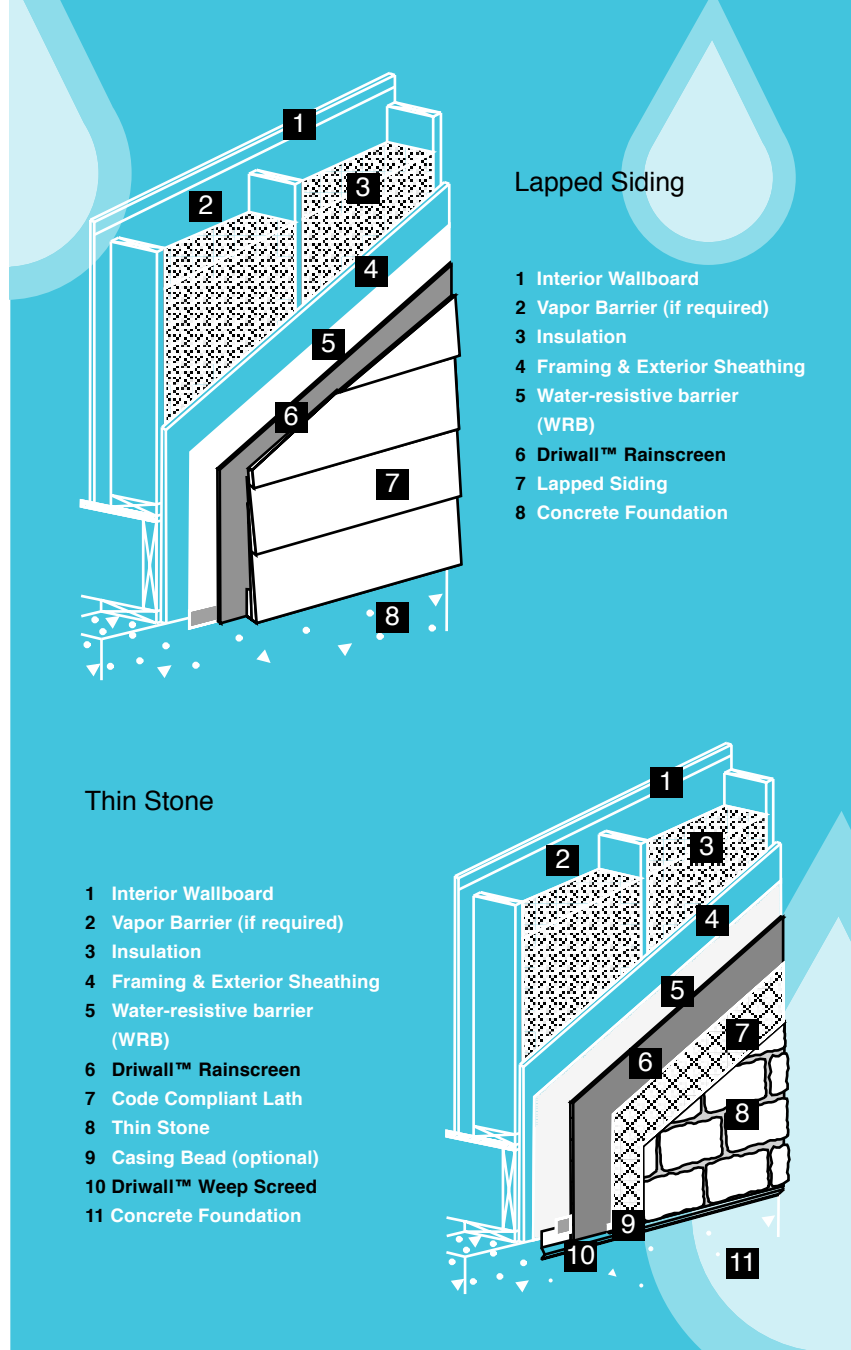



Driwall™ Rainscreen Products

Product	Thickness	Length	Area	Roll Dimension	Roll Weight	Applications
Driwall Rainscreen 020-1	0.25 in./6.0 mm	65 ft.	260 sq. ft.	16x16x48 in.	19.5 lbs.	See below
Driwall Rainscreen 10 mm	0.40 in./10.9 mm	45 ft.	180 sq. ft.	16x16x48 in.	24 lbs.	See below
Driwall Rainscreen 075-1	0.75 in./19.0 mm	50 ft.	200 sq. ft.	18x18x48 in.	29 lbs.	Brick and natural stone

For a complete list of all our products, please contact KBP, or visit our website at www.KeeneBuilding.com

Applications

- ✓ Stucco
- ✓ Thin stone or brick
- ✓ Manufactured stone
- ✓ Stone and brick masonry
- ✓ Lap siding
- ✓ Siding applications

Eliminate One Layer of Building Paper

- ✓ **IRC 2006 Code Book***
- ✓ **R703.6.3 Water-resistive barriers.** Water-resistive barriers shall be installed as required in Section R703.2 and, where applied over wood-based sheathing, shall include a water-resistive, vapor-permeable barrier with a performance at least equivalent to two layers of Grade D paper.
- ✓ **Exception:** Where the water-resistive barrier that is applied over wood-based sheathing has a water resistance equal to or greater than that of 60 minute Grade D paper and is separated from the stucco by an intervening, substantially non water-absorbing layer or designed drainage space.



P.O. Box 241353

Mayfield Heights, OH 44124

Info@KeeneBuilding.com

www.KeeneBuilding.com

877 | 514 | 5336

P 440 | 605 | 1020

F 440 | 605 | 1120