

Product Data

Driwall™ Weep Screed

Description

Driwall™ Weep Screed is used as a flashing & weep when paired with a water-resistive barrier (WRB) or building paper & Driwall™ Rainscreen.

It provides a clean termination for stucco, manufactured stone & thin natural stone at the bottom of the wall.

The unique “V”-shape allows migration of moisture down the screed & away from the wall.

This product is required by all major building codes & the International Building Code at the bottom of all framed walls.

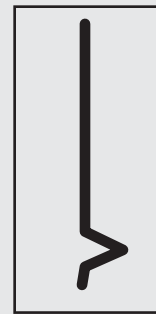

Profile view
of Driwall™ Weep
Screed

Features and Benefits

3 ½-Inch (89-mm) nailing and flashing flange

Color: gray

¾-Inch (19-mm) “V”-shaped drip edge

Each piece is 5-foot long

0.75 lbs. per piece

40 pieces per package

PVC material meets ASTM standards D1784, C1063 and D4216-99



Installation Instructions

Please see back of sheet

Installation Instructions

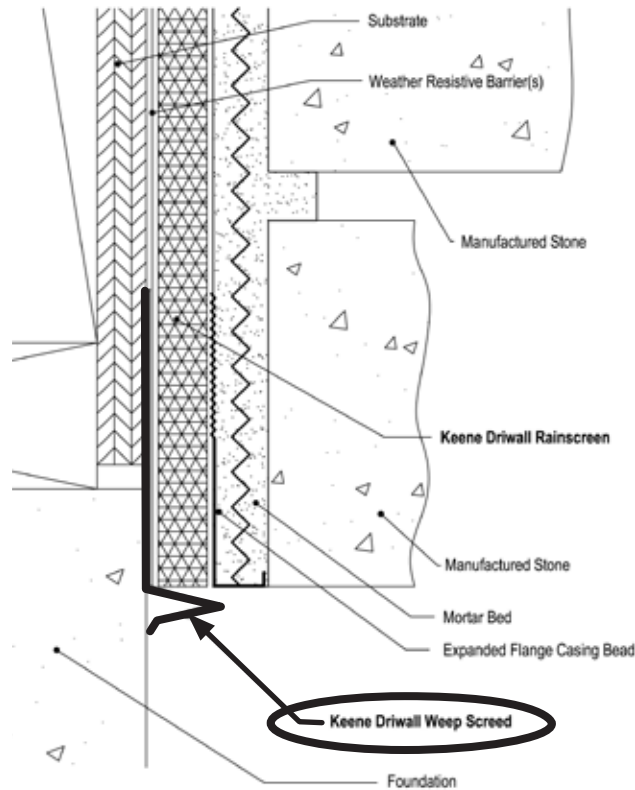

Install Driwall™ Weep Screenshot on frame construction where stucco, manufactured stone or thin natural stone & foundation wall meet.

Water-Resistive Barrier (WRB) or building paper should cover the top portion of the Driwall™ Weep Screenshot up to the drip edge.

This product should be used where specified by the architect & installed per industry standards & according to local code.

Caulk all butt joints, intersections & ends.

LIMITED WARRANTY: Keene Building Products, Inc. warrants to the initial purchaser only that the goods sold hereunder will be free from defects in material and workmanship and, except as otherwise set forth herein, will conform to the specifications provided. If any failure to meet this warranty appears within one year from the date of shipment of the goods, on the condition that Keene Building Products, Inc. will correct any such failure by either replacing or repairing any defective goods, at Keene Building Products, Inc.'s option.

The preceding paragraph sets forth the exclusive remedy for all claims based on failure of or defect in the goods sold hereunder, whether such failure or defect arises before or during the warranty period and whether a claim, however instituted, is based on contract, indemnity, warranty, tort (including negligence), strict liability or otherwise. The forgoing warranty is exclusive and is in lieu of all other warranties whether written, oral, implied or statutory.



P.O. Box 241353
Mayfield Heights, OH 44124
Info@KeeneBuilding.com
KeeneBuilding.com

877 | 514 | 5336
P 440 | 605 | 1020
F 440 | 605 | 1120

2/2
2017/1