

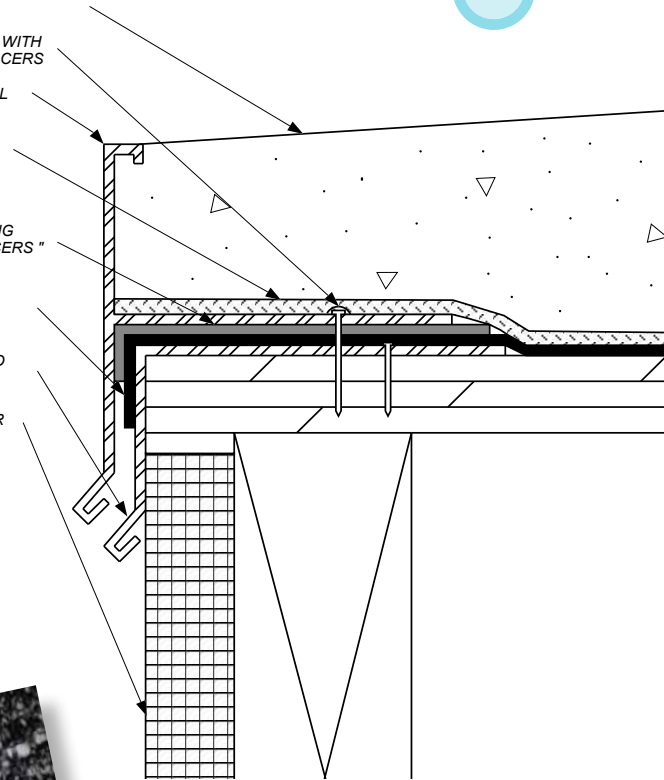

# Waterproofing and Drainage Solutions for Balconies and Breezeways in Multi-Family



CONCRETE SLAB  
 COVER NAIL HEAD WITH MASTIC @ ALL SPACERS  
 GALVANIZED METAL POUR STOP  
**DRIWALL™ PREFABRICATED COMPOSITE DRAIN**  
 1/8" SELF-ADHERING MEMBRANE " SPACERS " @ 12" O.C.  
**DRIWALL™ MEMBRANE**  
 .26 GA GALVANIZED DRIP EDGE  
 EXTERIOR VENEER



**Drivall™ Prefabricated Composite Drain (PCD) products are drainage mats designed to eliminate hydrostatic pressure from behind foundation walls, retaining walls, planters, plaza decks, and balconies.**

A filter fabric is heat-laminated to one side of the mat to hold soil or concrete away from the wall or deck and keep the drainage plane clear.



*Drivall™ PCD is 0.125 - 0.75 inches thick (3.175 - 19.0 mm thick)*

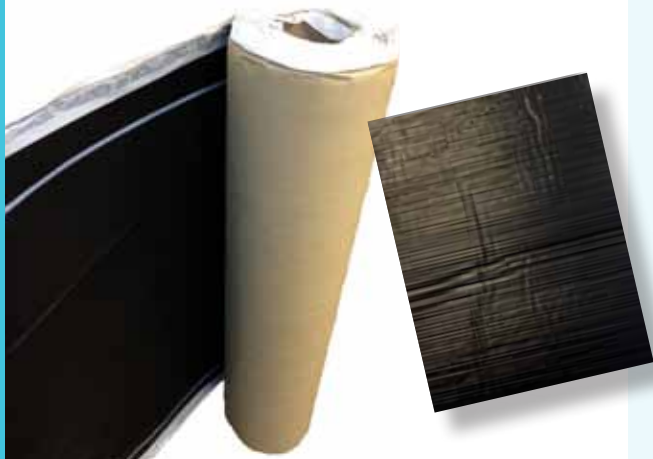

**Drivall™ Membrane is a self-adhering flashing and waterproofing membrane for full-wall or flashing applications in masonry, wood or gypsum construction. It provides an air and vapor barrier with excellent adhesion to concrete, galvanized metal, steel, plywood and gypsum.**

*Drivall™ Membrane 40 mil (1.0 mm thick and rolls are 75-feet long)  
 Drivall™ Membrane 60 mil (1.5 mm thick and rolls are 67-feet long)*



*For more information please contact*

**877-514-5336 • 440-605-1020**

**info@keenebuilding.com • www.keenebuilding.com**